

THERAPIST II 2-Channel Therapeutic Massager

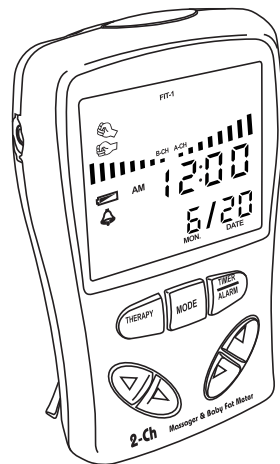

Model: 602F

INSTRUCTION MANUAL

Introduction

Thank you for purchasing the 2-Channel Therapeutic Massager with Body Fat Meter. Combining the built-in Body Fat Meter and the Electrode Therapeutic Pads, this is an ideal portable slimming tool for pain and stress relieving and body shaping. Two independent Channels including 4 powerful Electrode Pads work wonderful on almost anywhere for your body massaging. There are 8 intensity levels adjustable to fit your most comfortable needs. The automatic Therapy and Slimming Mode simplify the operation, which makes it easy to use. There are calendar and clock timer with alarm function useful while you were travelling. This Therapeutic Massager is going to give you a whole new experience of massaging simulation.

Before using the device, please read this operation manual thoroughly for the correct methods of usage especially the Notes on Safety. This manual should be kept available for future reference after you have read it thoroughly.

Features

- * Massage 7 Modes For Two Automatic Therapy , (Two Automatic Slimming Programs and 3 Single Manual Modes

- * Clock with Alarm
- * Two Channels Up to 4 Electrode Pads Can be Applied
- * 8 Adjustable Intensity Levels For 2 Independent Channels
- * Output Safety Protection
- * Large LCD Display the Massaging Function
- * Provide Safe and Drug-free Powerful Pain & Stress Relief
- * Detachable Desk Stand Bracket
- * Power source: Battery "AAA " x 3
- * Size/Weight: 121 x 75 x 27 mm / 150 gm

PRECAUTIONS BEFORE USE -

DANGER

NEVER use this instrument in combination with any of the following electronic medical devices because such use could result in a malfunction of the medical device:

- * Devices such as a pacemaker implanted in the body
- * Life-support devices such as artificial heart/lung equipment
- * Electronic medical equipments such as an electrocardiograph in use on or near the area of the body requiring treatment

WARNING

There is a possibility of serious injury or death if the device is used improperly in any of the ways listed below.

Introduction

Thank you for purchasing the 2-Channel Therapeutic Massager with Body Fat Meter. Combining the built-in Body Fat Meter and the Electrode Therapeutic Pads, this is an ideal portable slimming tool for pain and stress relieving and body shaping. Two independent Channels including 4 powerful Electrode Pads work wonderful on almost anywhere for your body massaging. There are 8 intensity levels adjustable to fit your most comfortable needs. The automatic Therapy and Slimming Mode simplify the operation, which makes it easy to use. There are calendar and clock timer with alarm function useful while you were travelling. This Therapeutic Massager is going to give you a whole new experience of massaging simulation.

Before using the device, please read this operation manual thoroughly for the correct methods of usage especially the Notes on Safety. This manual should be kept available for future reference after you have read it thoroughly.

Features

- * Massage 7 Modes For Two Automatic Therapy , (Two Automatic Slimming Programs and 3 Single Manual Modes

- * Clock with Alarm
- * Two Channels Up to 4 Electrode Pads Can be Applied
- * 8 Adjustable Intensity Levels For 2 Independent Channels
- * Output Safety Protection
- * Large LCD Display the Massaging Function
- * Provide Safe and Drug-free Powerful Pain & Stress Relief
- * Detachable Desk Stand Bracket
- * Power source: Battery "AAA " x 3
- * Size/Weight: 121 x 75 x 27 mm / 150 gm

PRECAUTIONS BEFORE USE -

DANGER

NEVER use this instrument in combination with any of the following electronic medical devices because such use could result in a malfunction of the medical device:

- * Devices such as a pacemaker implanted in the body
- * Life-support devices such as artificial heart/lung equipment
- * Electronic medical equipments such as an electrocardiograph in use on or near the area of the body requiring treatment

WARNING

There is a possibility of serious injury or death if the device is used improperly in any of the ways listed below.

In addition, if you are under medical treatment or are among any of the following groups of people, consult your physician and follow his or her directions regarding the use of this device:

- * Persons suffering from an acute illness
- * Persons who have a malignant tumor
- * Persons suffering from an infectious disease
- * Women who are menstruating or are pregnant
- * Persons with hearing problems
- * Persons suffering from a high fever (38°C or higher)
- * Persons suffering from abnormal skin sensations or skin conditions
- * Person suffering from high blood pressure (180 mmHg or higher)
- * Person whose physical condition is poor for reasons other than those above
 - a. Do not use this device near the heart, on the head or face, in the mouth, on the genitals or on areas of the body where there is skin disease
 - b. Do not use this device in combination with other therapeutic equipment or with topical medications
 - c. Do not attempt to repair or modify this device by yourself
 - d. Do not insert foreign objects into any openings on the device

CAUTION

There is a possible of bodily injury or damage to the device if it is used improperly in any of the following ways:

- * If use of the device results in skin irritation, discomfort or pain, discontinue to use immediately and consult your physician.
- * Do not use this device on infants or on persons who are unable to express how they feel physically, and do not leave this instrument within reach of such persons.
- * Do not use this device in the bathroom or in other area where there is high humidity. Also, Do not use this device while driving or while in bath or shower.
- * Do not use this device for other than therapeutic purposes.

Function of Controls and Component list

1.602 F consist of parts belowing:

- 1) Main Unit x 1
- (2) Electrode Pad x 4
- (3) Connection Wire for Pads x 2
- (4)Storage Plate x 2
- (5) Stand Bracket x 1
- (6) "AAA" Battery x 3
- (7) Instruction Manual x 1

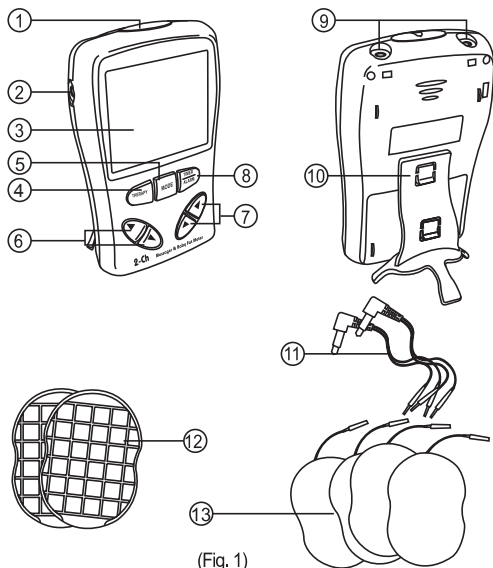

(Fig. 1)

2 Function controls and component

- (1) Alarm On/Off button
- (2) DC Jack
- (3) Large LCD Display
- (4) THERAPY button for massaging mode
- (5) MODE button for mode selection and exit function
- (6) Arrow buttons (B-channel)–Adjusting B-channel intensity level

- (7) Arrow buttons (A-channel) – setting and adjusting A-channel intensity level
- (8) TIMER/ALARM button to switch between time & alarm display
- (9) Jacks for electrode pads – insert the electrode pad cords
- (10) Stand Bracket – make the device be able to stand up on table
- (11) Electrode pads cord
- (12) Storage plates for storing electrode pads
- (13) 4 Electrode pads – stick on the body parts you wish to be massaged

Installation

Battery installation and replacement

* Slid the battery cover off and insert 3 “AAA” Batteries into battery compartment as Fig. 2 below

- Note:** (1) When first time install battery, unit auto. enter time setting mode, please refer to operation "A. Time Setting" for details
- (2) Batteries included are for testing purpose only, not to indicate a new battery service life.

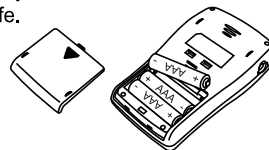

(Fig 2)

-Stand bracket installation (optional)

. Insert the upper parts into 2 slots as Fig. 3 shown -

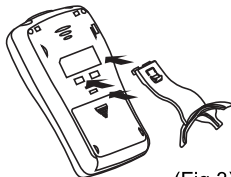

(Fig. 3)

Press protrude portion on the back of bracket to fix the bracket to the device as fig. 4 shown -

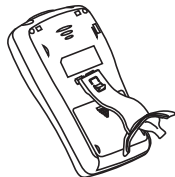

(Fig. 4)

To detach the bracket, press the protrude portion and pull outward to disassembly it.

Operation

A. Time setting

Please make sure to use the A-channel (right hand side) “▲” and “▼” buttons for the time and alarm adjust.

- (1) Press and hold the “TIMER/ALARM” button for 2 seconds while in real time display, to enter the Time Adjusting Mode, the “Year-digit” blinking
- (2) Press the “▲” or “▼” button to adjust to current Year
- (3) Press the “MODE” button you will see “Month-digit” blinking, press the “▲” or “▼” button to adjust to current Month
- (4) Press the “MODE” you will see “Date-digit” blinking, press the “▲” or “▼” button to adjust to current Date
- (5) Press the “MODE” you will see “Hour-digit” blinking, press the “▲” or “▼” button to adjust to current Hour
- (6) Press the “MODE” you will see “Minute-digit” blinking, press the “▲” or “▼” button to adjust to current Minute
- (7) Press the “MODE” button to save your settings

B. Alarm setting -

While the display in real time Mode, press “TIMER/ALARM” button, to switch to Alarm display (The Alarm Time will show up for 10 seconds, if there is no any key pressed then return to real time display)

- (1) Press and holding “TIMER/ALARM” button for 2 seconds to enter to the Alarm setting mode and you will see “Hour-digit” blinking.
 - (a) Press the “▲” or “▼” button to adjust the Hour-digit of Alarm Clock you desired

- (b) Press the "MODE" button you will see "Minute-digit" blinking, press the "▲" or "▼" button to adjust the Minute of Alarm Clock you desired
- (c) Press "MODE" button to save your settings and exit the setting mode. "Alarm" sign will show on the screen after you completing the alarm clock setting. Also, you may press Alarm On/Off Button on the top of unit to turn alarm off or on.

C. Therapy Setting and Operation

Be sure to read "PRECAUTIONS BEFORE USE" on page 2. Before using therapy function, make sure the pads are connected to the device and attached to the body properly.

- (1) Press "THERAPY" button to enter the Therapy Setting Mode
- (2) Press "MODE" button repeatedly to choose one of the therapy modes you like among THER-1, THER-2, FIT1, FIT2, and SINGLE
 Remark: THER1:Basic auto. therapeutic massage programe
 THER2:Intensive auto therapeutic massage program
 FIT1: Basic auto slimming aid program
 FIT2: Intensive auto therapeutic massage program
 SINGLE:Choose one of TAPPING ,PUSHING or KNEADING modes

- (3) Press "TIMER/ALARM" to choose the timer of 05, 10, 15, 20, 25 or 30 minutes.
- (4) Press the A-channel "▲" button to start and adjust the level you desired. You can using "▼" to decrease the intensity level.
- (5) Press B-channel "▲" or "▼" button to adjust the intensity levels in B-channel.
- (6) When the set timer up, the unit will exit to standby mode.
- (7) During the Therapy mode, you can Press "MODE" button anytime to reset the "A and B-channel" intensity levels go back to "zero" for emergency protection. To press and hold the "MODE" button for 2 seconds will exit the Therapy Mode.

Note:

- * Cleanse the area of your body to be treated before attaching the pads
- * Make sure that the electrode pads do not come in contact with metal objects, such as jewelry, as this could result in sudden stimulation.
- * After use, please store the electrode pads to the storage plate.
- * If you experience unusual or uncomfortable sensations during use, discontinue to use immediately and consult your physician.
- * Attaching the electrode pads to skin that is not clean will impair the adhesion of the pads and shorten their service life. If the adhesive becomes weak, wipe the pads and then wet the adhesive with a cloth moistened with water. This

should improve the pads' adhesion. If adhesion is still poor, replace the electrode pads. Do not overlap the pads. Do not pull or bend the pads and cords.

- * When battery low, the unit will display with low battery icon and exit the Therapy mode immediately. Please replace with 3 new "AAA" alkaline batteries.
- * Attach the pads to your body where you feel pain or stiffness or desire a massage. Following is the examples and suggested attachment points for reference –

Examples

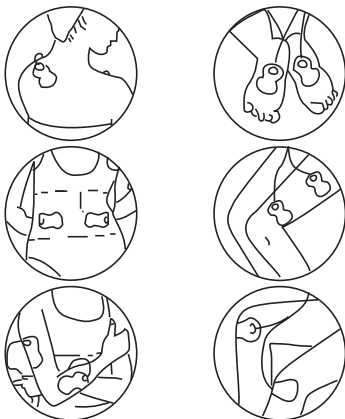

Attachment points -

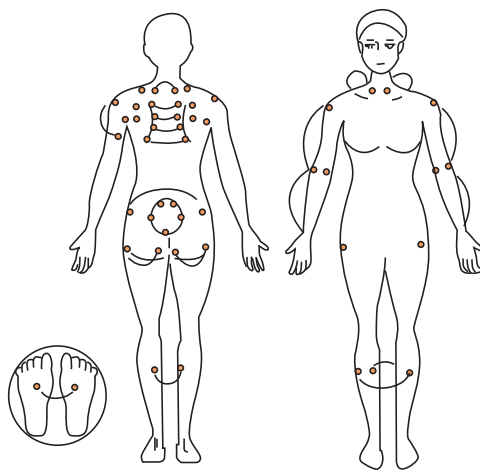

Maintenance

- * Use a dry cloth when cleaning the device. Never use a wet cloth, use a cloth lightly dampened with water if desired
- * Do not use alcohol, benzene, thinner or other harsh chemicals to clean the device
- * Do not drop the device
- * Do not disassemble any parts and repair under no indication
- * Do not leave the device in direct sunlight or high humidity for a long period of time
- * It is advisable that the massager be stored in a dust and moisture free environment, to prevent from affecting the functions
- * Be sure to switch off the device after using and before cleaning
- * Wipe the electrode pads with slight damped cloth every time after using, that will make the pads last longer

Troubleshooting

Problem	Possible cause and solution
No LCD display No stimulation is felt	* Check if the battery polarity is correctly installed. Or the battery worn out, please reinstall the battery or replace with 3 new "AAA" alkaline batteries.
Stimulation is weak even Set to a stronger levels	* Battery power low, please replace with new batteries
During use ,a strong shock is felt	* Check the electrode pad attached securely to the Skin, or the pads have sufficient adhesion. Please reposition the pads or replace a new pads.
The pad's adhesive side is discolored	* Discoloration may occur, this is normal and poses no problems
The device stops functioning even if It has not been used for 15 minutes	* The batteries are exhausted. Replace with new batteries